

## MILLENNIUM SERIES

### Stainless Steel Euro-Profile Swing Handle

#### Features

- Vandal resistant
- Park position with “click”
- Semi flush
- IP65 rated
- Suits 40mm profile cylinders (sold separately)
- 90° left & right stopper
- **NOT compatible** with high security Euro-profile "push button tube lock" cylinders (as commonly used in zinc-die 1107SCCU3 & 1107SBCU3 variants)

#### Dimensions

- Shaft length: 68mm
- Square shaft size: 8mm

#### Materials & Finish

- **Base:** Stainless steel cast alloy CF-8M (equivalent to wrought stainless steel AISI 316)
- **Handle:** Stainless steel cast alloy CF-8M (equivalent to wrought stainless steel AISI 316)
- **Shaft:** Stainless steel 316
- **Cover:** Black Polyamide
- **Base finish:** Mirror-like
- **Handle finish:** Mirror-like

#### Cams Available

- Adjustable single point: 1000-1586
- Adjustable 3 point with adapters: 1000-1587
- Adjustable 3 point without adapters: 1000-1588



Part Number	Cylinder Type	Base Finish	Handle Finish	Cutout Template
1107SSSU3	Euro-Profile	Stainless Steel 316	Stainless Steel 316	Selectrix/Standard (No Hole In Base)

## MILLENNIUM SERIES

### Stainless Steel Euro-Profile Swing Handle

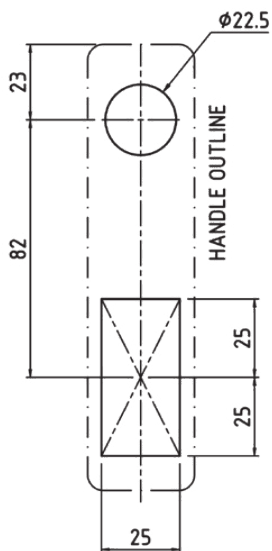

**SELECTRIX®** cut out

