

CONCEALED CORNER HINGE (PI5346)

FSDT Range

F-Series Symmetrical Door Technology

Features

- Semi-concealed design
- Mounting: Rear fixing, M5 stud
- Suits door thickness: 1.5~2.3mm
- Modularity and symmetry: Perfect for biaxial symmetrical designed door frames. Once installed in combination with enclosures using either, F Cutout door profile or F Cutout Adapter Plate + Millennium/Eselon/Evolution swing handles.
- PI5346 hinge system: Enables 180° rotational door symmetry, allowing same-hinge suitability for both LH / RH door orientations.
- F-Series Symmetrical Door Technology: Engineered to support our advanced FSDT range of products.

Materials & Finish

- Hinge body: Zinc die-cast, EDP coated (matte black/black)
- Pin: Mild steel or Delrin®
- Dimensions: 65mm (L) x 20mm (W) 22mm (D)

Remarks

- For optimal results: Selectlok recommend the use of this FSDT Concealed Corner Hinge (*PI5346*) with handles featuring either a dedicated F-Series profile design, or the use of an F Cutout Adapter Plate and enclosures featuring biaxial symmetrical designs and manufacturing.



Part Number	Pin Material	Fixing	Body Finish	Door Thickness
PI5346-MB-6-2-S	Mild Steel	Rear, M5 Stud	Matte Black	1.5mm ~ 2.3mm
PI5346-B-6-2-S	Mild Steel	Rear, M5 Stud	Black	1.5mm ~ 2.3mm
PI5346-B-1-2-S	Delrin	Rear, M5 Stud	Black	1.5mm ~ 2.3mm

CONCEALED CORNER HINGE

FSDT Range

F-Series Symmetrical Door Technology

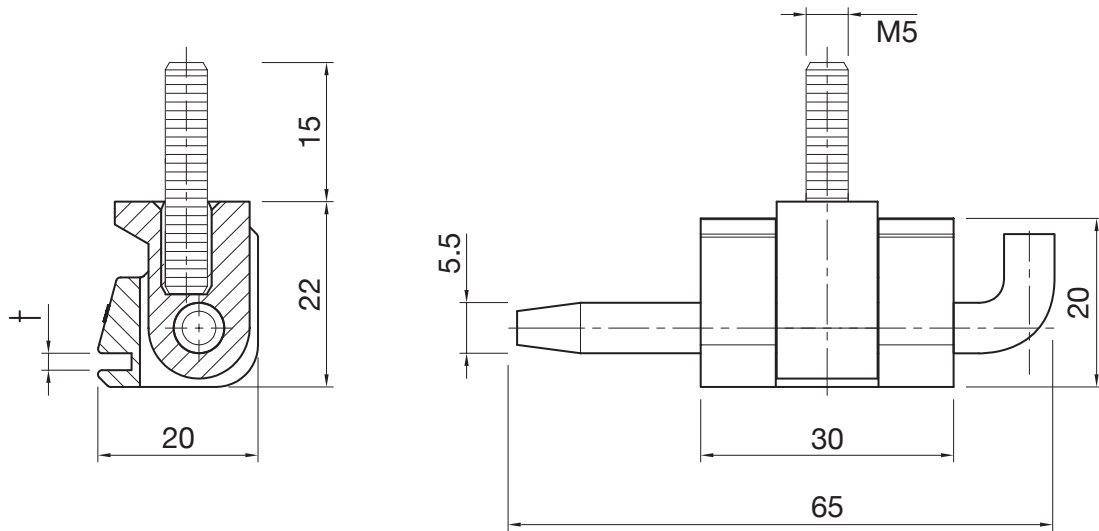

MODULAR SYMMETRY DOOR FRAME DESIGNS.

Biaxial symmetry at the frame is essential to rotating the door around its centre point.

Remarks



For optimal results: Selectlok recommend the use of this FSDT Concealed Corner Hinge (**PI5346**) with doors and enclosures featuring biaxial symmetrical designs and manufacturing processes.

