

## NP0044

### Folding-T Handle with Mounting Bracket

Manually Actuated (MLA) and/or Integrated Electronic Central Locking (ELS)

#### Features

- Aesthetically pleasing, contemporary design
- Keyed alike: CH05, CH06, CH08, CH09
- Rear fixing, mounting bracket
- Operational features:
  - Folding-t operation
  - Manually actuated locking (MLA) handles
  - Integrated electronic central locking (ELS) handles
  - Manual key override for ELS handle variants
  - Integrated padlock hasp (Ø8mm)
  - 90° handle rotation
  - Adjustable three-point roller cam
- Compatible power supplies:
  - 12V (*only*) switching or non-switching
- Rear fixing, mounting bracket
- Supplied with gasket

#### Dimensions, Materials & Finish

##### Dimensions

- Handle dish: 139mm (H) x 139mm (W) x 80mm (D)
- Cutout profile: 106mm (H) x 90mm (W)
- Grip range: 28mm ~ 48mm (H=)
- Roller:
  - Short - 19.8mm (L) x Ø17mm / Ø16.7mm (dia/taper)
  - Long - 34.5mm (L) x Ø17mm / Ø16.7mm (dia/taper)

##### Material & Finish

- Handle and dish: Zinc alloy, die-cast
- Cam, shaft and bracket mount: Zinc die-cast, zinc plated
- Roller: Glass fibre reinforced polyamide (PA6)
- Colour and finish:
  - Black, powder-coated
  - Chrome plated



#### Remarks

**Includes:** 2x alternative length roller options (interchangeable)

**Compatible with:** ELS | NP0044: electronic central locking, 6V/12V control box and shunt.

**Compatible power supplies:** 12V (*only*) switching or non-switching

- Can be hardwired into existing vehicle central locking system or installed “wirelessly” via standalone 12V power supply.
  - Can also be configured into integrated systems alongside ELS variants of our NP0044: push-button compression latches.
- (Incorporate with: ELS | NP0044: push-button compression latches & electronic central locking, 6V/12V control box and shunt)

## NP0044

### Folding-T Handle with Mounting Bracket

Manually Actuated (MLA) and/or Integrated Electronic Central Locking (ELS)

#### MANUALLY ACTUATED LOCKING (MLA) HANDLES

Part Number	Description	Actuation	Power Supply (Voltage)	Keyed	Colour / Finish
NP0044-001-CH05	NP0044   Folding-T w/ Mounting Bracket	Manual Actuation (MLA)	Not Applicable	CH05	Black PC
NP0044-001-CH06	NP0044   Folding-T w/ Mounting Bracket	Manual Actuation (MLA)	Not Applicable	CH06	Black PC
NP0044-001-CH08	NP0044   Folding-T w/ Mounting Bracket	Manual Actuation (MLA)	Not Applicable	CH08	Black PC
NP0044-001-CH09	NP0044   Folding-T w/ Mounting Bracket	Manual Actuation (MLA)	Not Applicable	CH09	Black PC
NP0044-002-CH05	NP0044   Folding-T w/ Mounting Bracket	Manual Actuation (MLA)	Not Applicable	CH05	Chrome PLT
NP0044-002-CH06	NP0044   Folding-T w/ Mounting Bracket	Manual Actuation (MLA)	Not Applicable	CH06	Chrome PLT
NP0044-002-CH08	NP0044   Folding-T w/ Mounting Bracket	Manual Actuation (MLA)	Not Applicable	CH08	Chrome PLT
NP0044-002-CH09	NP0044   Folding-T w/ Mounting Bracket	Manual Actuation (MLA)	Not Applicable	CH09	Chrome PLT

#### INTEGRATED ELECTRONIC CENTRAL LOCKING (ELS) HANDLES

Part Number	Description	Actuation	Power Supply (Voltage)	Keyed	Colour / Finish
NP0044-003-CH05	NP0044   Folding-T w/ Mounting Bracket	Int. Central Locking (ELS)	12V (only) Switching/Non-Switching	CH05	Black PC
NP0044-003-CH06	NP0044   Folding-T w/ Mounting Bracket	Int. Central Locking (ELS)	12V (only) Switching/Non-Switching	CH06	Black PC
NP0044-003-CH08	NP0044   Folding-T w/ Mounting Bracket	Int. Central Locking (ELS)	12V (only) Switching/Non-Switching	CH08	Black PC
NP0044-003-CH09	NP0044   Folding-T w/ Mounting Bracket	Int. Central Locking (ELS)	12V (only) Switching/Non-Switching	CH09	Black PC
NP0044-004-CH05	NP0044   Folding-T w/ Mounting Bracket	Int. Central Locking (ELS)	12V (only) Switching/Non-Switching	CH05	Chrome PLT
NP0044-004-CH06	NP0044   Folding-T w/ Mounting Bracket	Int. Central Locking (ELS)	12V (only) Switching/Non-Switching	CH06	Chrome PLT
NP0044-004-CH08	NP0044   Folding-T w/ Mounting Bracket	Int. Central Locking (ELS)	12V (only) Switching/Non-Switching	CH08	Chrome PLT
NP0044-004-CH09	NP0044   Folding-T w/ Mounting Bracket	Int. Central Locking (ELS)	12V (only) Switching/Non-Switching	CH09	Chrome PLT

## NB

ELS | ECL | IECL | MLA

Acronyms; Commonly associated w/ reference to the actuation methods of our range of **Electronic Locking Solutions** products.

- **Including:** Electronically powered central locking actuator kits (6V/12V/24V), digital access and smart locking systems, electronic lock positioning (park) sensors, control boxes, shunt connectors, remote controls and batteries, etc.

ELS: Electronic Locking Solutions  
 ECL: Electronic Central Locking  
 IECL: Integrated Electronic Central Locking  
 MLA: Manual Locking Actuation

## NP0044

### Folding-T Handle with Mounting Bracket

Manually Actuated (MLA) and/or Integrated Electronic Central Locking (ELS)

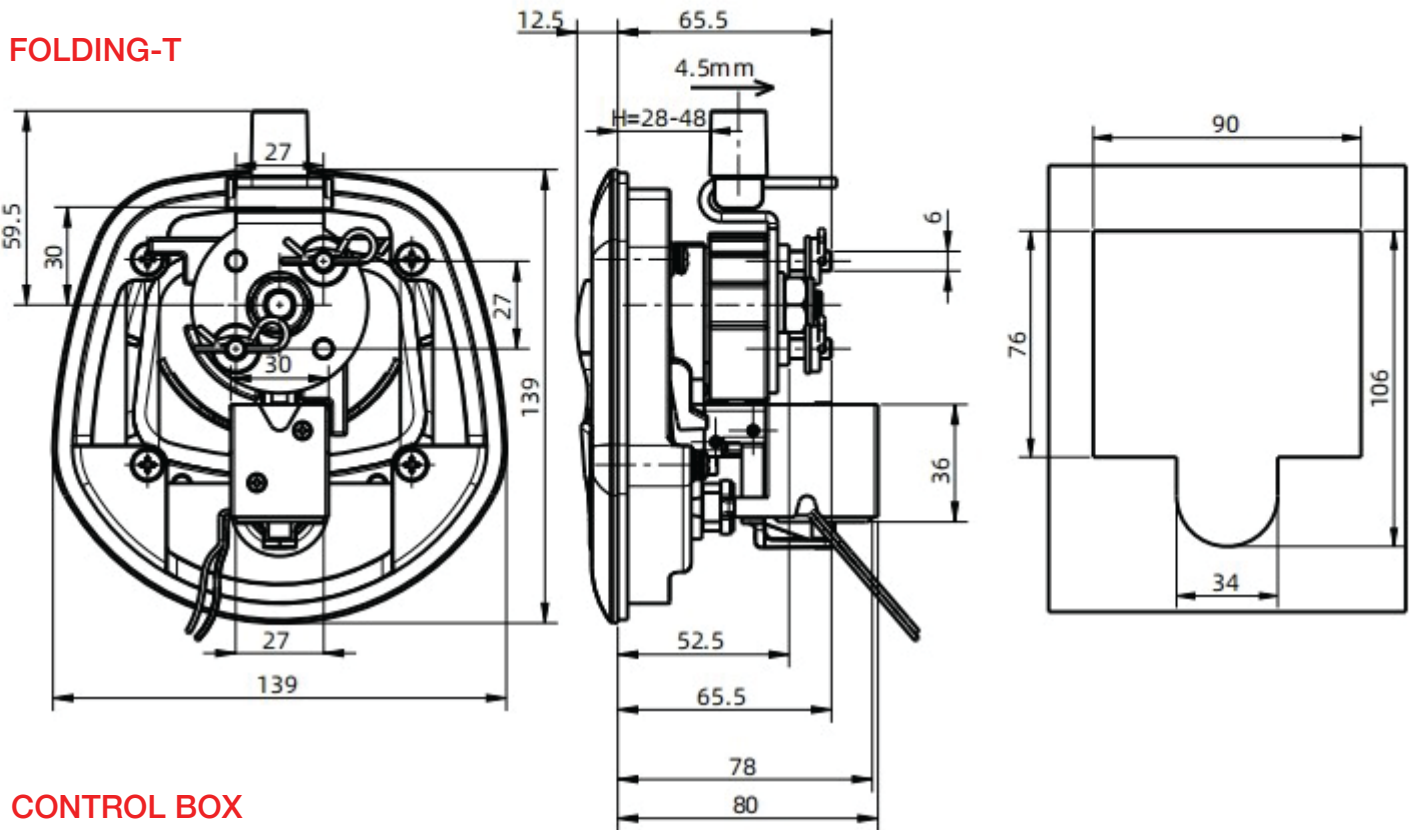

## CONTROL BOX

