

## CONCEALED CORNER HINGE

### Modular Symmetry Door Frame Designs

F-Series

#### Features

- Semi-concealed design
- Rear fixing, M5 stud
- Suits door thickness: 1.5~2.3mm
- Designed for use with modular symmetry door frame (MSDF) applications

#### Materials & Finish

- **Hinge body:** Zinc die-cast, EDP coated (matte black/black)
- **Pin:** Mild steel or Delrin®
- **Dimensions:** 65mm (L) x 20mm (W) 22mm (D)

#### Remarks

- **For optimal results:** When designing symmetrical enclosure door frames, Selectlok recommends the pairing of **PI5346-MB-6-2-S** concealed corner hinges with our **F-Series** (cutout) range of symmetrical swing handles on frames where biaxial symmetry is essential to rotating the door around its centre point.



Part Number	Pin Material	Fixing	Body Finish	Door Thickness
PI5346-MB-6-2-S	Mild Steel	Rear, M5 Stud	Matte Black	1.5mm ~ 2.3mm
PI5346-B-6-2-S	Mild Steel	Rear, M5 Stud	Black	1.5mm ~ 2.3mm
PI5346-B-1-2-S	Delrin	Rear, M5 Stud	Black	1.5mm ~ 2.3mm

## CONCEALED CORNER HINGE

### Modular Symmetry Door Frame Designs

F-Series

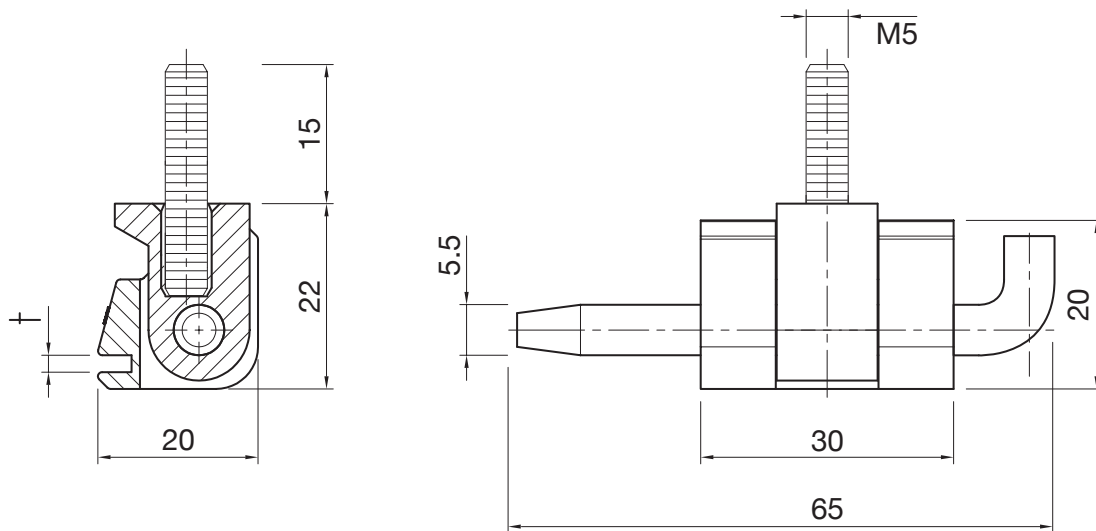

#### MODULAR SYMMETRY DOOR FRAME DESIGNS.

*Biaxial symmetry at the frame is essential to rotating the door around its centre point.*



#### Remarks

**For optimal results:** When designing symmetrical enclosure door frames, Selectlok recommends the pairing of our PI5346-MB-6-2-S concealed corner hinges with our F-SERIES (cutout) range of symmetrical swing handles.

