

GLASS DOOR HINGE

MATERIAL & FINISH:

- Adaptor plate for glass doors
- To suit Dirak Snap-Line hinge part no. 417-9015.00-01216
- Left or right hand applications
- Zinc die cast/black powder coated

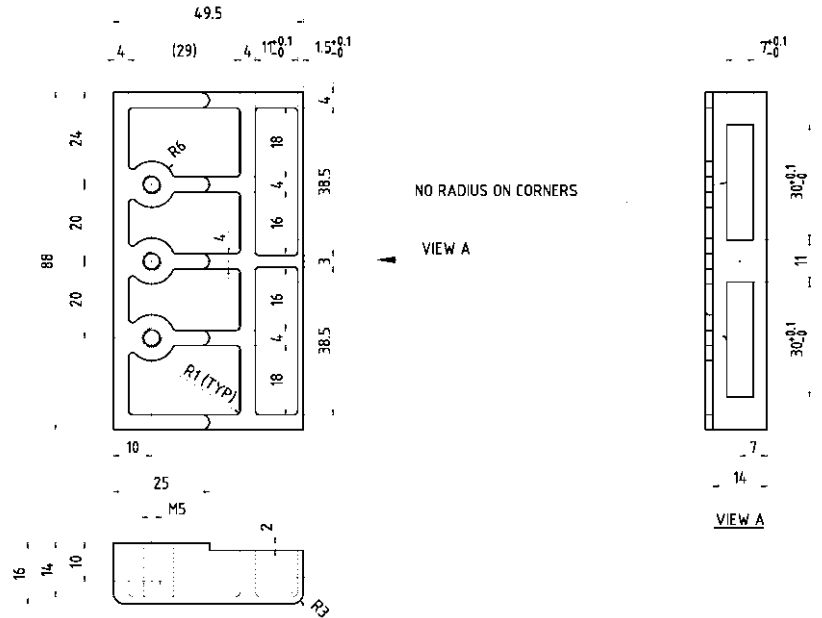
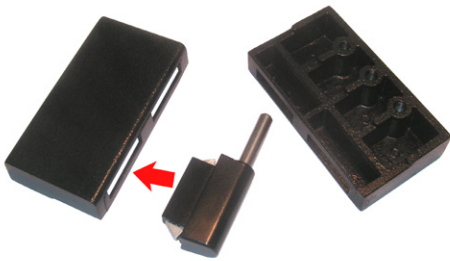

MATERIAL	FINISH	PART NUMBER
Zinc die cast	Black powder coated	P3185

TORQUE BUTT HINGE

FEATURES:

- Zinc die cast/nanometer plating
- Stainless steel shaft
- 90° rotation

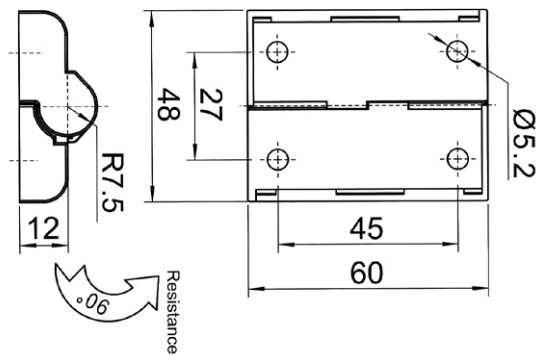

MATERIAL	FINISH	PART NUMBER
Zinc die cast	Silver nanometer	CL299-1-Z