

TEAR DROP QUARTER TURN

FEATURES:

- IP65 Rated
- Reduced fixing time
- Fully Assembled
- Detent for positive latching

DIMENSIONS:

Housing Length = 18mm
Escutcheon = 28mm

MATERIAL & FINISH:

Housing Zinc die, Chrome plated
Insert Polyamide
Cam Mild steel, Zinc plated

CAM DIMENSIONS:

Refer to [page 1-14](#) when ordering

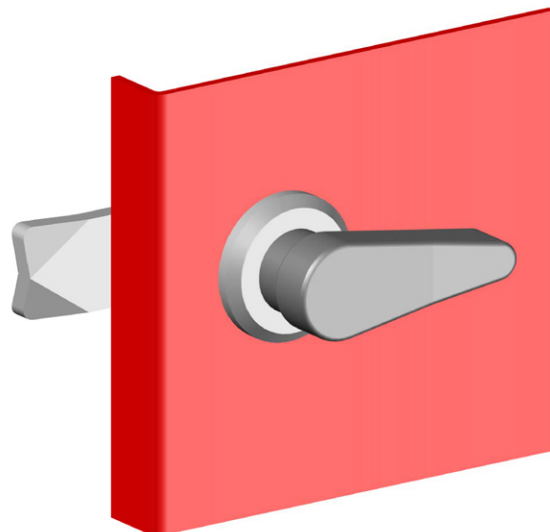
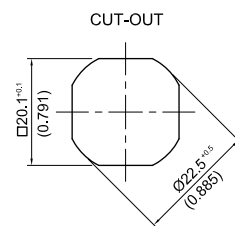
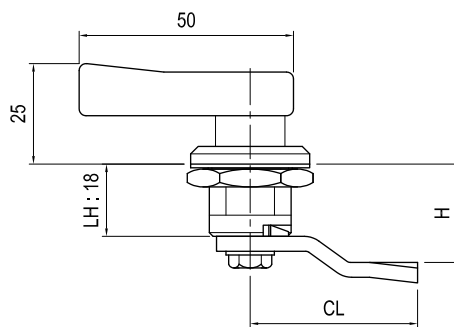

Convert to compression style with [PI5124](#) ([page 2-14](#))

HOUSING DESCRIPTION	PART NUMBER
Zinc die cast with 28mm escutcheon	TL818
Zinc die cast with 32mm escutcheon	TL818-32